



**Digital Cylinder (Z4)
HZ, HZ DK/MR**

ZS40.990536
23.08.2021

DE Kurzanleitung
EN Quick guide
FR Guide abrégé
NL Korte handleiding
IT Guida breve
DK Korte vejledning
SE Snabbguide



3 Variants

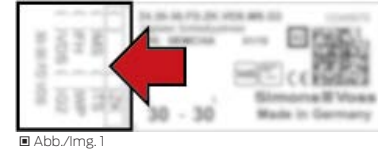

5 Installing the HZ cylinder

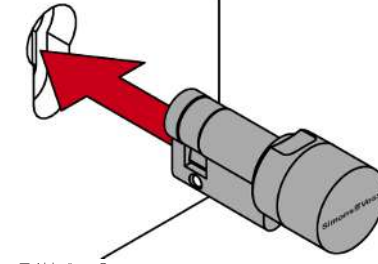

6 Installing the HZ DK cylinder

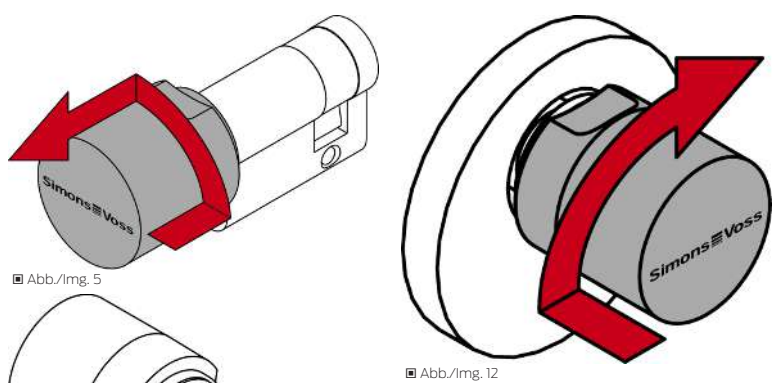
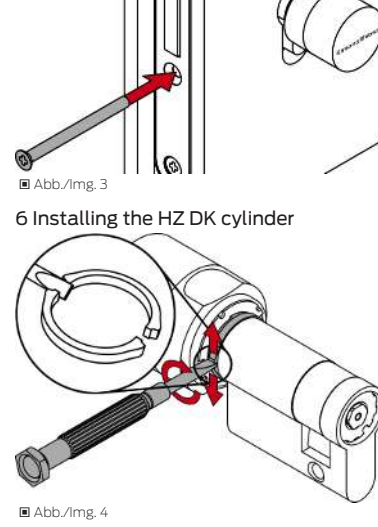

7.1 Battery replacement (active cylinder)

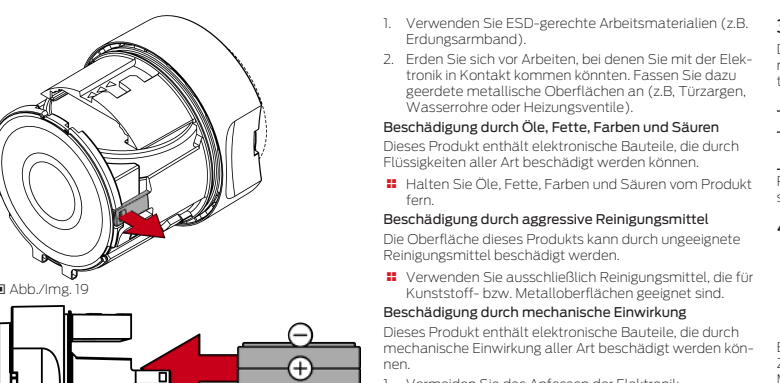
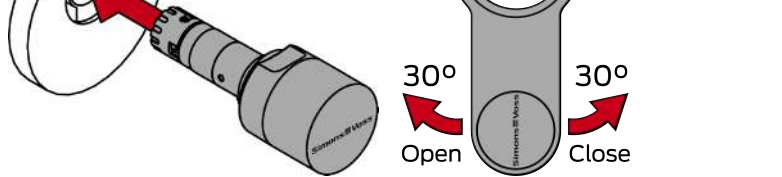
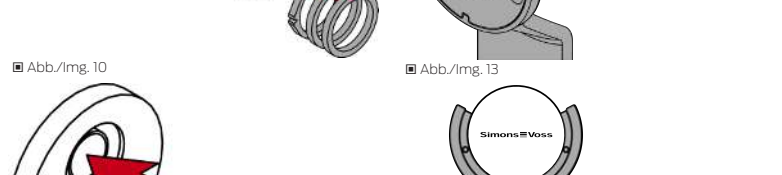
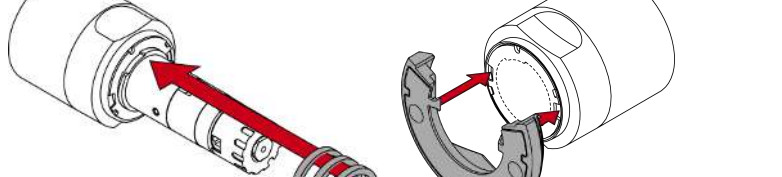
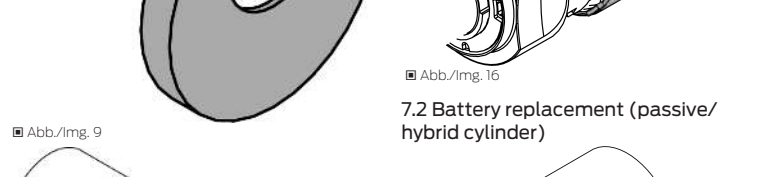
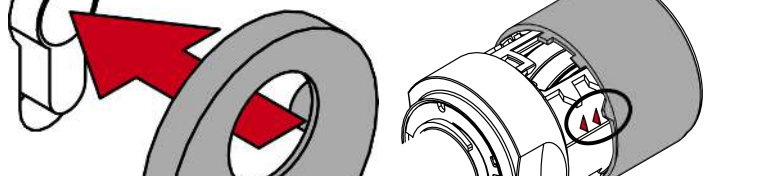
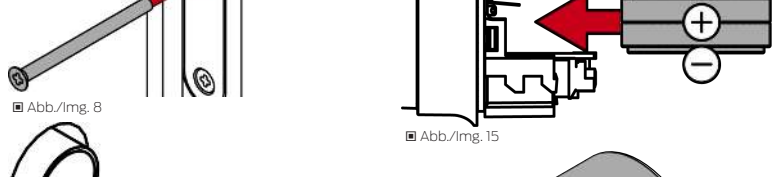
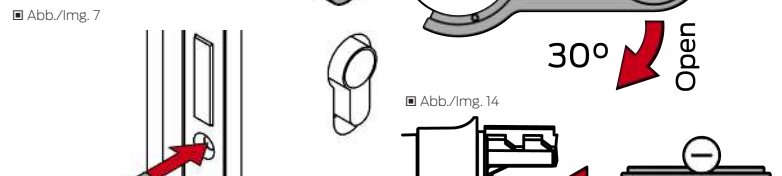
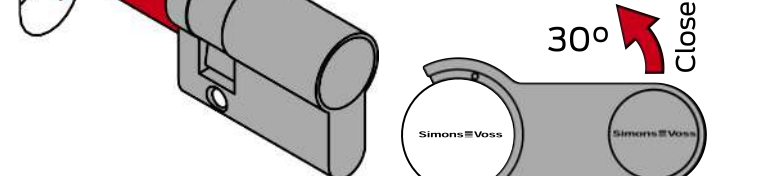
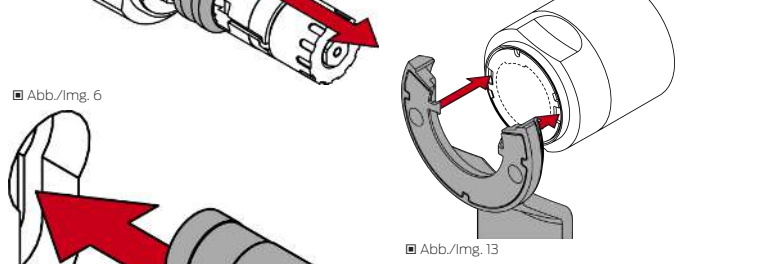

7.2 Battery replacement (passive/hybrid cylinder)

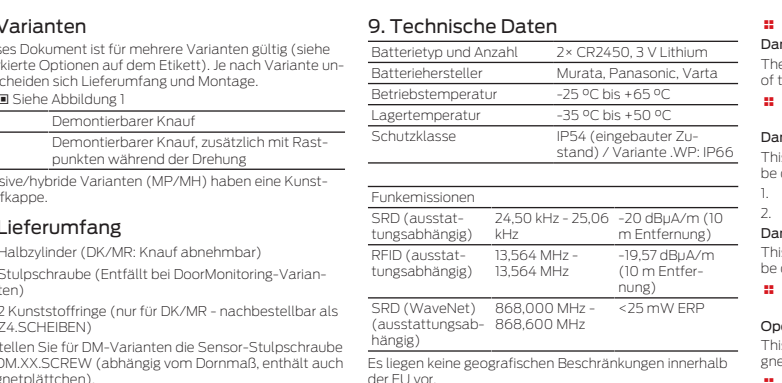
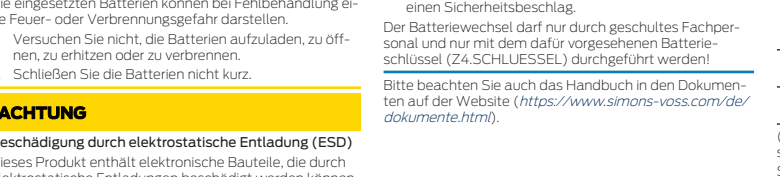
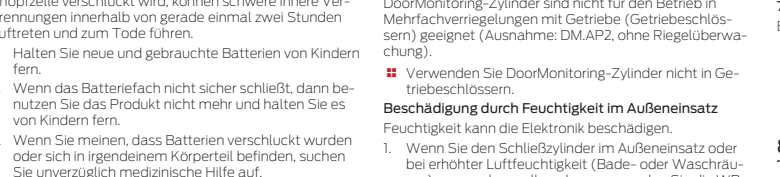
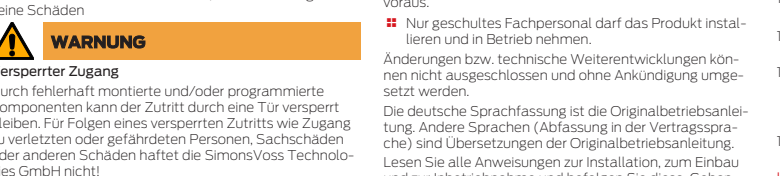
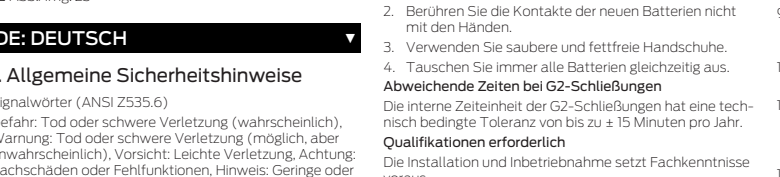
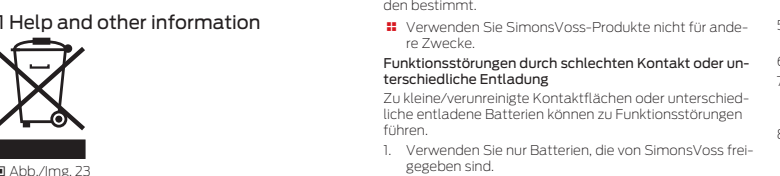

10 EU/UK Declaration of conformity

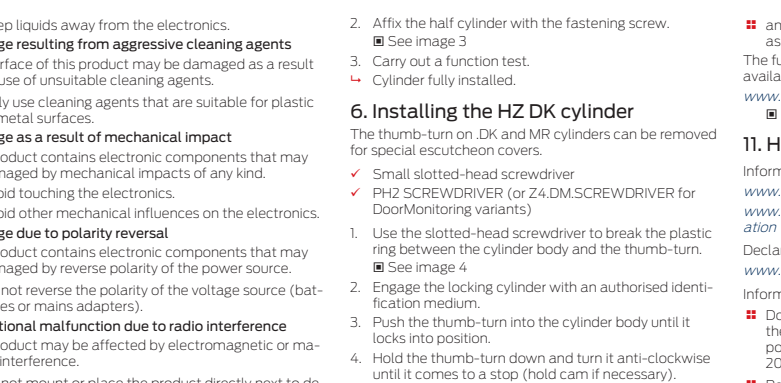
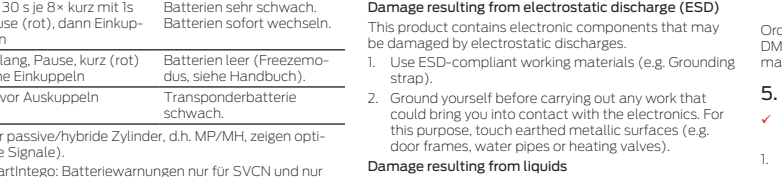
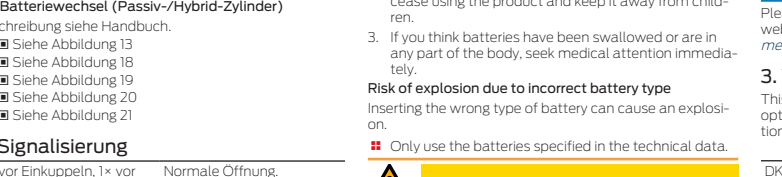
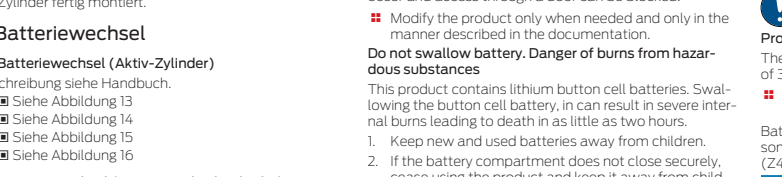
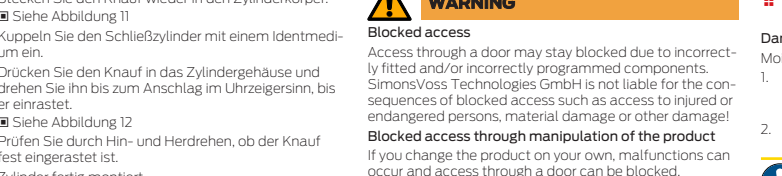
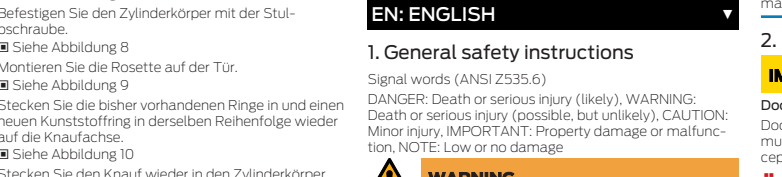
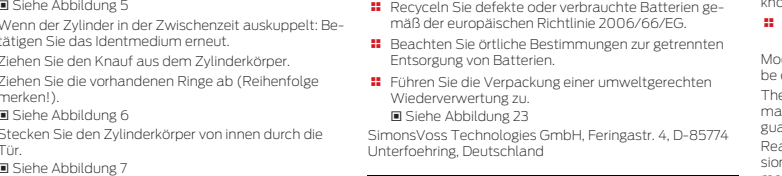
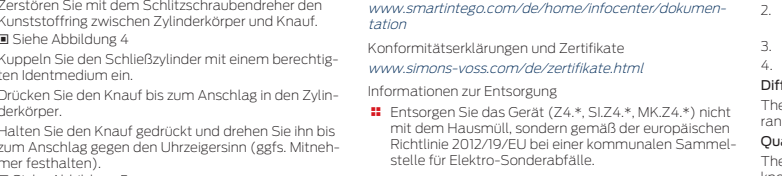
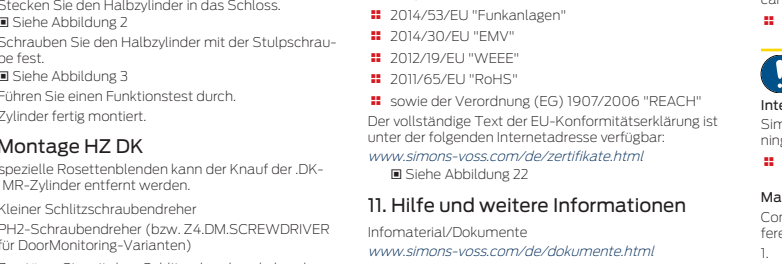

11 Help and other information

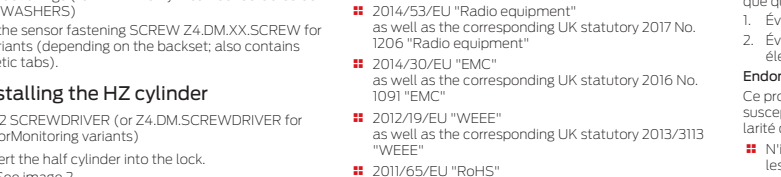
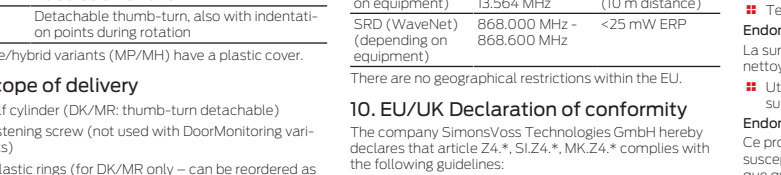
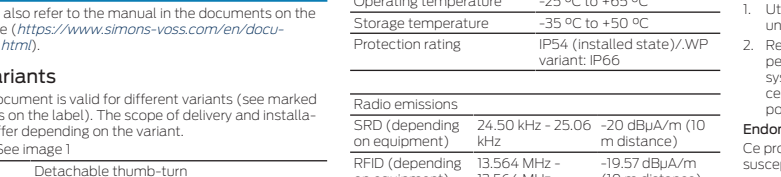
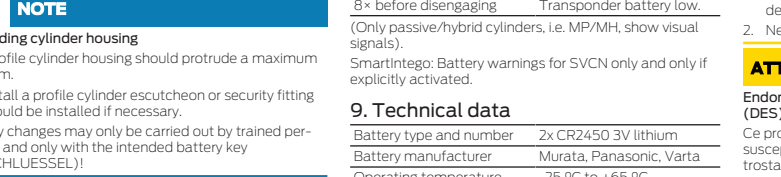
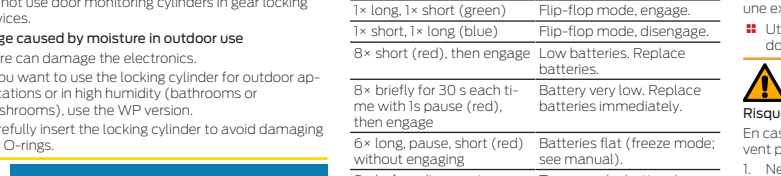
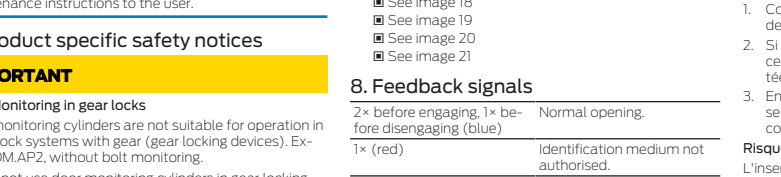
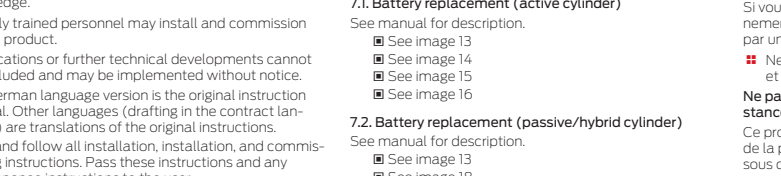
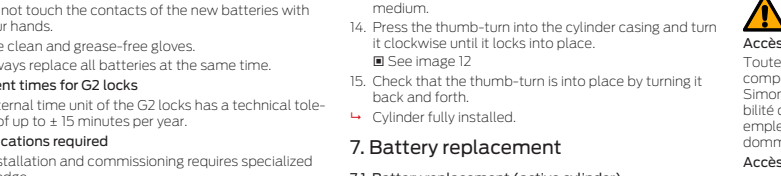
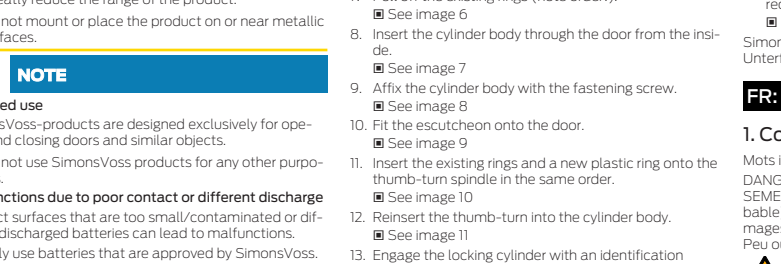

11. Help and other information

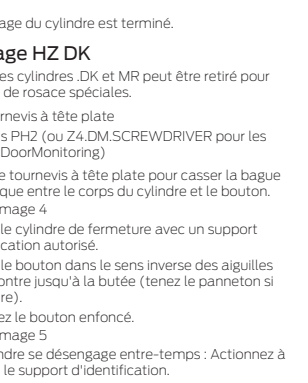
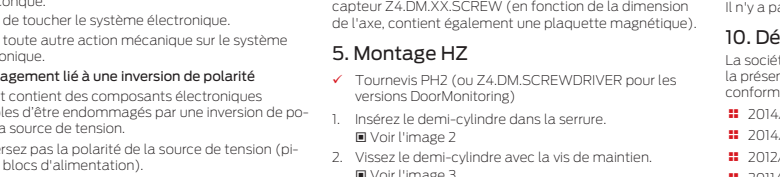
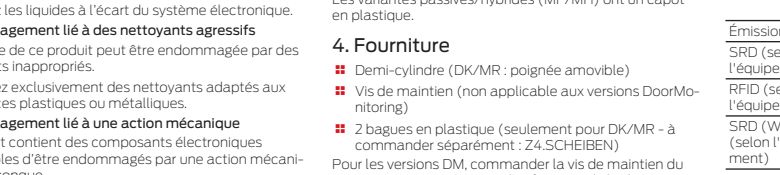
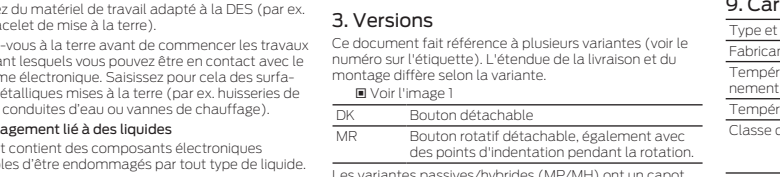
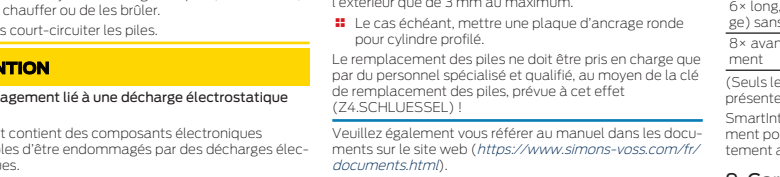
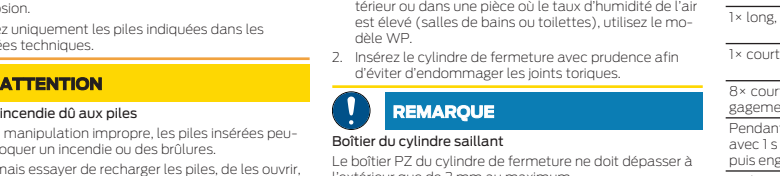
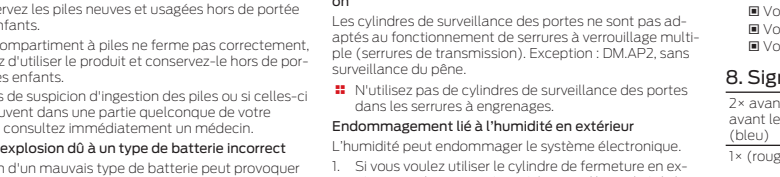
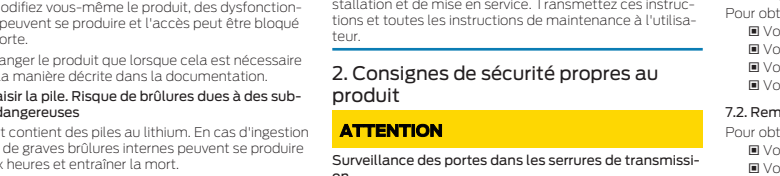
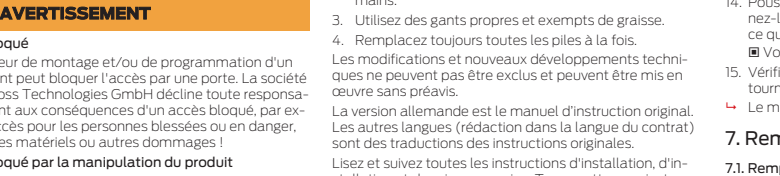
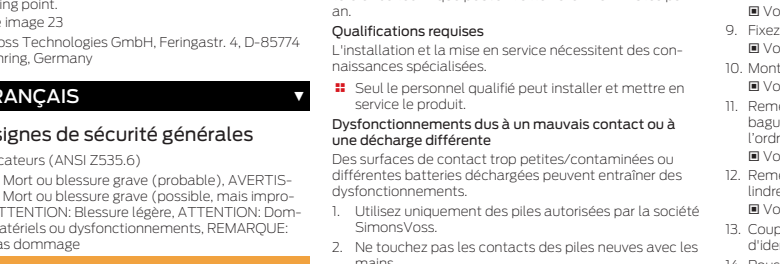

6. Montage HZ DK

