



// **FEATURES**

- ⌘ Cable-free networking of all locking devices
- ⌘ Ensures seamless cooperation between peripherals and software.
- ⌘ Data exchange in real time
- ⌘ Range of up to 30 metres
- ⌘ Connection to integrator management software via IP/Ethernet interface
- ⌘ Radio communication over 868 MHz, with AES 128-bit encryption
- ⌘ Power supply via PoE or external power supply
- ⌘ Optional external antenna

// **TECHNICAL DATA**

General		Protection rating		IP20
Dimensions (W x H x D)	172 mm x 86 mm x 33 mm	Electrics		
Weight	About 100 g	Operating voltage	9 V _{DC} to 32 V _{DC} (reverse polarity protected) or PoE as per IEEE 802.3af	
Material	ABS plastic, UV-stable	Power supply via PoE and round plug possible at the same time: Round plug > 12 V _{DC} → round plug used. Round plug < 12 V _{DC} → PoE used		
Colour	White (similar to RAL 9016 Traffic white)	Output	Max. 3W	
Installation	<ul style="list-style-type: none"> ⌘ Horizontal ⌘ Vertical ⌘ Wall installation possible ⌘ Integrated strain relief (3x) 	Interfaces		
Connections	<ul style="list-style-type: none"> ⌘ RJ45 (network/PoE) ⌘ Round plug Ø 5.5 mm, Ø pin 2.0 mm (power supply) ⌘ Screw terminal block, 2-pole, wire diameter between 0.14 mm² and 1.5 mm² (power supply for external applications) ⌘ MCX socket (optional external antenna) 	RJ45	<ul style="list-style-type: none"> ⌘ Network interface ⌘ 10T/100T ⌘ HP Auto_MDX ⌘ DHCP client (DHCP: on) ⌘ 1Pv4 ⌘ Services: <ul style="list-style-type: none"> ⌘ TCP: 1x at Port 2101 ⌘ UDP: 1x for Digi-Scan (OAM tool) ⌘ Web server: enable 	
Environment		868 MHz radio	WaveNet interface, range up to 30 m	
Temperature range	Operational: -10 °C to +55 °C Storage: -20 °C to +60 °C	Feedback signals		
Humidity	Max. 90%, non-condensing	LED	RGB LED (centre of housing)	
		Software		
		Programming	via TCP/IP interface	
		Radio emissions		
		SRD (WaveNet)	<ul style="list-style-type: none"> ⌘ 868 MHz to 868 MHz ⌘ <25 mW ERP 	
		There are no geographical restrictions within the EU.		

// DIMENSIONS

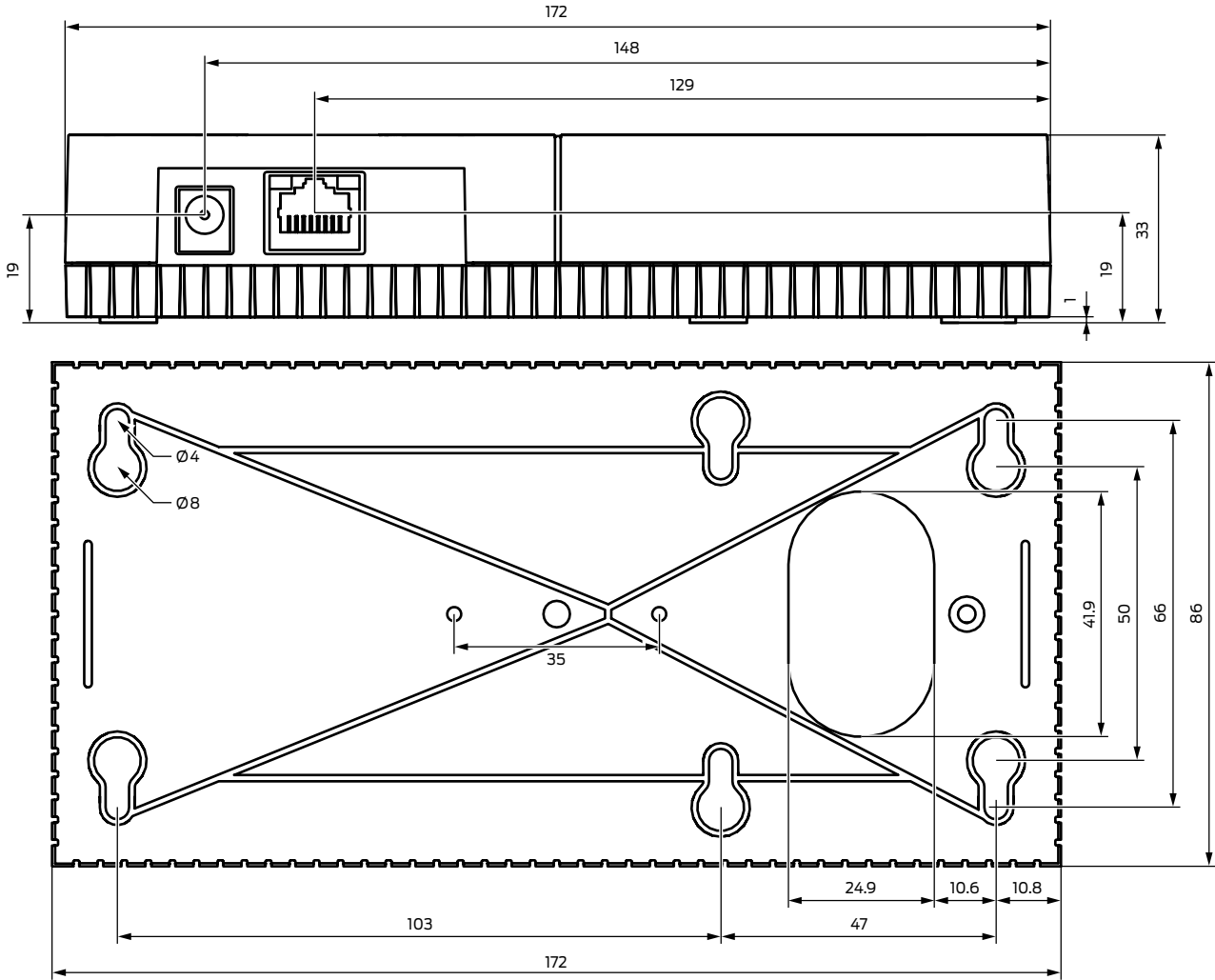

// OPTIONAL EXTERNAL ANTENNA

Electrical characteristics		Connection specifications	
Type	Multi-band antenna	Connection	MCX male
Frequencies	<ul style="list-style-type: none"> ■ AMPS (824–894 MHz) ■ GSM (900 MHz) ■ DCS (1800 MHz) ■ PCS (1900 MHz) ■ 3G (UMTS 2.1 GHz) 	Cable	RG174U
Impedance	50 Ohm	Cable length	250 cm
Polarisation	Linear	Mechanical specifications and dimensions	
Repetition	2.2 dBi max.	Fastening	Magnetic attachment
VSWR	<3:1	Material	ABS
Operating temperature	-40 °C to +85 °C	Max. dimensions	30.9 x 71.5 mm (Ø x H)
		Weight	50 g 'Connection with cable mounted from above'
		Colour	Black

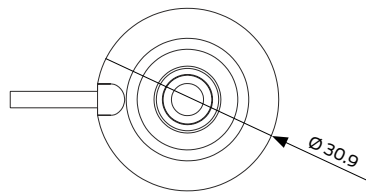
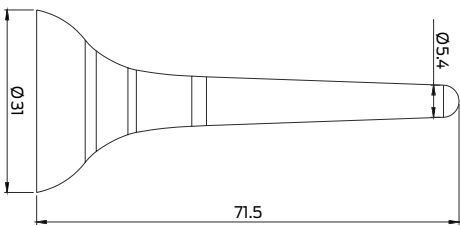

See price list for further variants, options and accessories.

Measurements indicated in mm